



SCI QUAL
INTERNATIONAL

QUALITY APPROVED TO AS/NZS ISO 9001:2008
REGN. Number 3313

JAS-ANZ



THE ONLY ACCREDITED CERTIFIED
COMPANY IN AUSTRALIA

Family Flair



Family Flair Standard Features

Chassis

- Lightweight Supagal Chassis
- 195 X 15" Tyres Alloy Rims
- 8" Jockey Wheel
- Electric Brakes
- Drop Down Jacks
- Leaf Spring Suspension
- Looped Bumper Bar/ 3rd Arm
- Spare Wheel Fitted To B.Bar
- Bike Rack Provision
- Straight Axle
- Lockable Coupling With
- Twin Safety Chains
- Pre Coated Timber One Piece Floor
- Hydraulic Jack
- Jack Handle

Interior

- Sliding Pantry With Basket
- Where Applicable
- Frosted Glass Doors
- OHC With Gas Struts
- OHC 20" Above Dinette
- Porta Provision Under Bed
- (Non Shower Vans)
- Laminex Edging Bench Tops
- Full Laminex Splashback
- Robes With Built In Dresser &
- Drawer/Mirror Doors
- 1 X Drawer Under Dinette
- All Drawers On Steel Runner
- (Where Applicable)
- Pots & Pans Drawers (Where Applicable)
- Timber Pelmets
- Venetian Blinds
- Curtains On Bunk Windows

- Pillow Upholstery
- Queen Innerspring Mattress
- Bunk Beds
- Bed Spread
- Bathroom Accessories
- Fire Extinguisher
- Clock
- Soap Container At Sink
- Fibreglass Step
- Concertina Door
- Royal Flair Mats

Exterior

- Timber Meranti Frame Work
- Wind Out Tinted Windows
- Security Door
- Roll Out Awning
- Full Insulation
- Front Large Galvanised Pebble
- Guard Storage Boot
- Front Pebble Guard Up To Boot
- Front Stone Shield
- Grab Handles Front/Rear
- Galvanised Wheel Arches
- Wheel Spats
- External Drop Down Table
- Hatches
- Raised Walls
- Checker Plate Sides

Electrical

- 100 AMP Battery & Charger
- 40 AMP Circuit Breaker
- Breakaway
- External LED Lighting
- All 12V Lighting

- External Speaker
- Fridge RM7851 175Lt
- Stainless Steel Microwave
- Cormorant A/C
- Wine Guard Antenna
- CD/Radio/MP3 Player And Speakers
- LCD/DVD Combo
- Gas Detector
- 12V Range Hood
- External Handle Light
- Annex Light
- Light In Boot
- Roof Mounted DVD Player with screen &
- Headphones Under Each Bunk

Plumbing

- 12 Volt Pump
- Aframe Mains Pressure Tap
- Stainless Steel Sink
- Chrome Flick Mixer Tap
- Lockable Water Filter
- City Mains Pressure Inlet
- Drain Tap Fitted To Water Tank
- Fibreglass Moulded Shower
- Aluminum Frame Shower Door
- 12Volt Fan Hatch To Shower
- Gas/Electric HWS (Shower Vans Only)
- Ceramic Vanity
- 2 X 4kg Gas Bottle
- 95Ll Water Tank Fitted With Stone Guard
- Water Gauge
- 1 X Electric 3 X Gas Mini Grill
- Toilet
- 3 Way Slide Out BBQ

Complimentary Gifts: Royal Flair Towel Sets & Apron

www.royalflair.com.au



QUALITY APPROVED TO AS/NZS ISO 9001:2008
REGN. Number 3313

JAS-ANZ



ROYAL FLAIR CARAVANS
PROUDLY SPONSORED BY
HUME CARAVANS &
CAMPING ACCESSORIES
NCE PERFECT WOOD MOULDING
THETFORD
PLENTY RIVER PLUMBING
G&S CHASSIS
THE CAMEC GROUP

THE ONLY ACCREDITED CERTIFIED
COMPANY IN AUSTRALIA

Family Flair



FF01 19'9 X 7'9

TARE: 1875 kg BALL WT: 200 kg

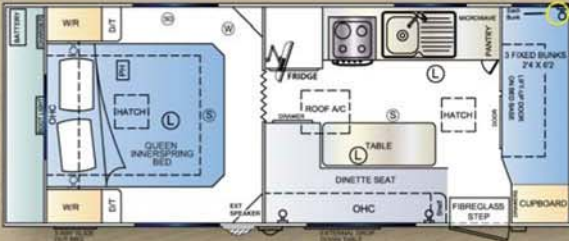

FF02 20'9 X 7'9

TARE: 1905 kg BALL WT: 175 kg

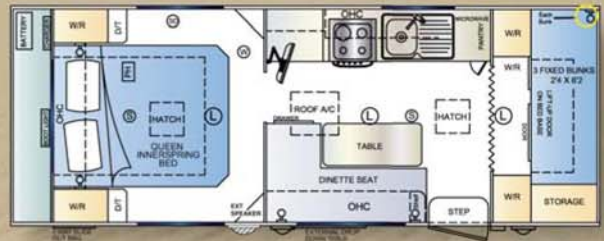

FF03 21'4 X 7'9

TARE: 1940 kg BALL WT: 280 kg

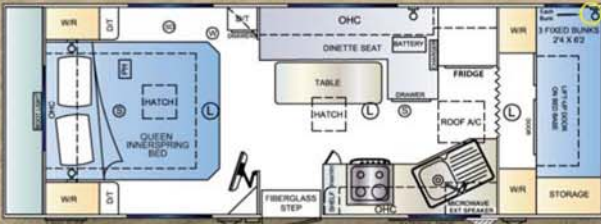

FF04 23'4 X 7'9

TARE: 2240 kg BALL WT: 225 kg

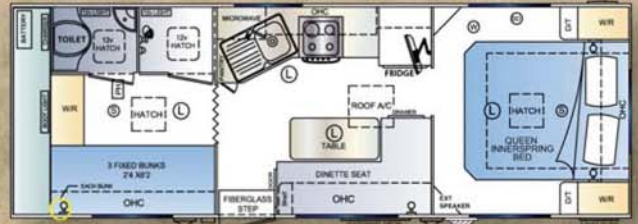

FF05 20'9 X 7'9

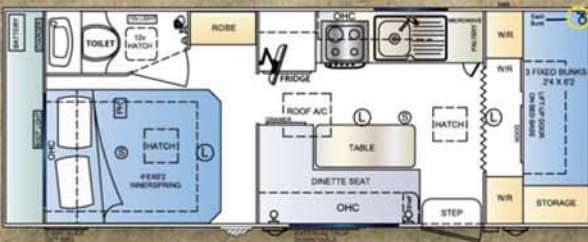

FF06 21'8 X 7'9

TARE: 2180 kg BALL WT: 200kg

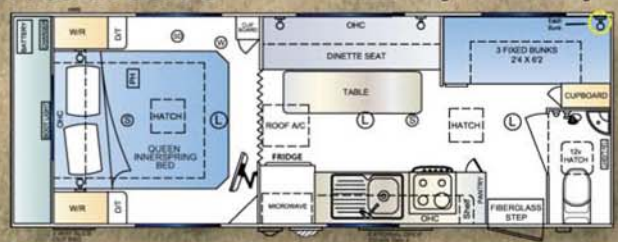

ROYAL FLAIR CARAVANS
26-28 Merola Way,
Campbellfield, Victoria 3061
PH: (03) 9357 8118 FAX: (03) 9357 8330
EMAIL: sales@royalflair.com.au

Dealer